

antal

Winches XT series
FAMILY ARTICLE
Exploded view
DESCRIPTION

XT70.3/CH
Powered version
MODEL CODE

07/02/2019	00
DATE	REV.
17060801	2 / 3
DWG N.	PG.

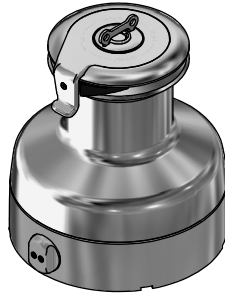

PART LIST				PART LIST			
CODE	DESCRIPTION	MATERIAL	Q.TY	CODE	DESCRIPTION	MATERIAL	Q.TY
Y-W0434	Disengagement rod head	S.Steel	1	B12837	Roller bearing	Plastic / S.Steel	1
Y-W0484	Fork roll pin	S.Steel	2	B2519	Roller bearing	Plastic / S.Steel	5
Y-W0485	Fork	Aluminium	1	B4219	Roller bearing	Plastic / S.Steel	1
Y-W0514	Bearing track	Plastic / S.Steel	1	B4234	Roller bearing	Plastic / S.Steel	2
Y-W0515	Threaded axis	S.Steel	1	B7035	Roller bearing	Plastic / S.Steel	1
Y-W0516	Fork stand	Aluminium	1	SFT001	Torlon ball 13/32"	Plastic	46
Y-W0517	Fork lever	Aluminium	1	Y-W0003	Upper ring	S.Steel	1
Y-W0520	Gear "A3"	Bronze	1	Y-W0006	Upper ring washer	Plastic	1
Y-W0521	Lower shaft	S.Steel	2	Y-W0018	Stripper	Plastic	1
Y-W0524	Dual gear "D2 / D3"	Bronze	1	Y-W0020	Drum extension	Chromed brass	1
Y-W0526	Gear "B2"	Bronze	1	Y-W0022	Pipe spacer	S.Steel	2
Y-W0713	ST central disk	Chromed brass	1	Y-W0023	Bearing track	Plastic / S.Steel	1
Y-W0721	Opening tool	S.Steel	1	Y-W0032	Gear ring	S.Steel	2
Y-W0875	ST arm	Chromed brass	1	Y-W0049	ST disk bush	Plastic	4
Y-W0940	Disengagement rod	S.Steel	1	Y-W0082	Stem	Chromed brass	1
Y-W1020	Spindle	S.Steel	4	Y-W0083	Gear base	Aluminium	1
Y-WA001	ST-spring assy	S.Steel	4	Y-W0086	Gear spindle	S.Steel HR	1
Y-WA006	3 speed button unit	Various	1	Y-W0087	Gear spindle	S.Steel HR	1
Y-WA055	Main shaft	S.Steel / Bronze	1	Y-W0088	Plastic spacer	Plastic	1
Y-X0052	Screw	S.Steel	2	Y-W0100	Base	Aluminium	1
Y-X0052	Screw	S.Steel	2	Y-W0101	Half-ring	Brass	2
Y-X0054	Screw	S.Steel	1	Y-W0112	Shaft spacer	Plastic	1
Y-X0058	Screw	S.Steel	1	Y-W0132	Shaft washer	S.Steel	1
Y-X0062	Screw	S.Steel	1	Y-W0141	Pawl	S.Steel	12
Y-X0069	Screw	S.Steel	6	Y-W0143	ST plug	Plastic	6
Y-X0071	Screw	S.Steel	4	Y-W0163	Skirt	Aluminium	1
Y-X0072	Washer	S.Steel	2	Y-W0195	Gear upper washer	Plastic	2
Y-X0072	Washer	S.Steel	6	Y-W0199	Gear lower washer	Plastic	2
Y-X0081	Nut	S.Steel	1	Y-W0242	Gear "A2"	Bronze	2
Y-X0087	Pawl spring	S.Steel	12	Y-W0243	Gear "B1"	Bronze	1
Y-X0173	Screw	S.Steel	3	Y-W0245	Gear "D1"	Bronze	1
Y-X0179	Screw	S.Steel	2	Y-W0302	ST upper disk	Chromed brass	1
Y-X0184	Washer	Tufnol	2	Y-W0307	ST lower disk	Chromed brass	1
Y-X0189	Nut	S.Steel	1	Y-W0316	Drum	Chromed brass	1
Y-X0196	Compression spring	S.Steel	1	Y-W0373	Bearing bush	Chromed	2
Y-X0892	Nut	S.Steel	2	Y-W0387	Washer	S.Steel	2

PART LIST			
CODE	DESCRIPTION	MATERIAL	Q.TY
Y-W0132	Shaft washer	S.Steel	1
Y-W0254	Skirt flange	Aluminium	1
Y-W0278	Platic washer	Plastic	1
Y-W0380	Ball Bearing	S.Steel	1
Y-W0404	Disengagement box	Aluminium	1
Y-W0411	O-ring cup	S.Steel	1
Y-W0412	Disengagement	Brass	1
Y-W0413	Lower coupling	S.Steel	1
Y-W0414	Thrust ring	Bronze	1
Y-W0420	Stud	Various	1
Y-W0427	Horizontal gearbox	Various	1
Y-W0436	Gearbox cap	Plastic	1
Y-W0437	Motor flange	Aluminium	1
Y-W0486	Gearbox shaft	Brass	1
Y-W0535	Upper coupling	S.Steel	1
Y-W0716	Stud	S.Steel	1
Y-WA062	Packing ring	NBR rubber	1
Y-X0072	Washer	S.Steel	6
Y-X0073	Washer	S.Steel	4
Y-X0075	Seeger	S.Steel	1
Y-X0081	Nut	S.Steel	1
Y-X0135	Screw	S.Steel	8
Y-X0147	Screw	S.Steel	3
Y-X0150	Compression spring	S.Steel	3
Y-X0151	O-Ring	NBR rubber	1
Y-X0153	Screw	S.Steel	3
Y-X0154	Washer	Tufnol	1
Y-X0159	Parallel key	S.Steel	1
Y-X0169	Screw	S.Steel	4
Y-X0892	Nut	S.Steel	2

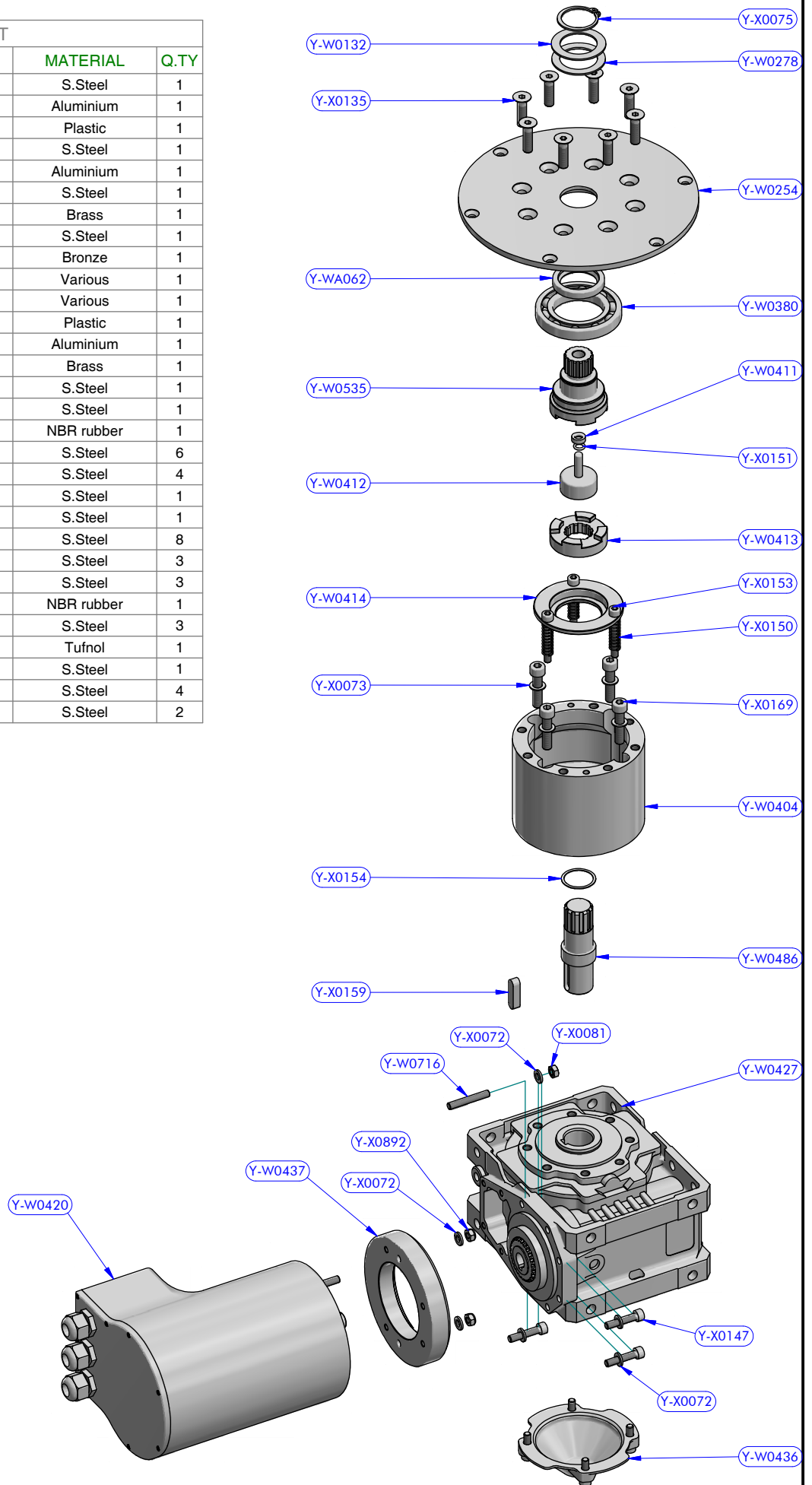

antal

FAMILY: XT series
 ARTICLE: Horizontal drive assy
 DESCRIPTION: Exploded view

MODEL CODE: Y-WA113

DATE: 18/05/2020
 DWG N.: 20051810
 REV.: 01
 PG.: /